

JetMAX Ultra

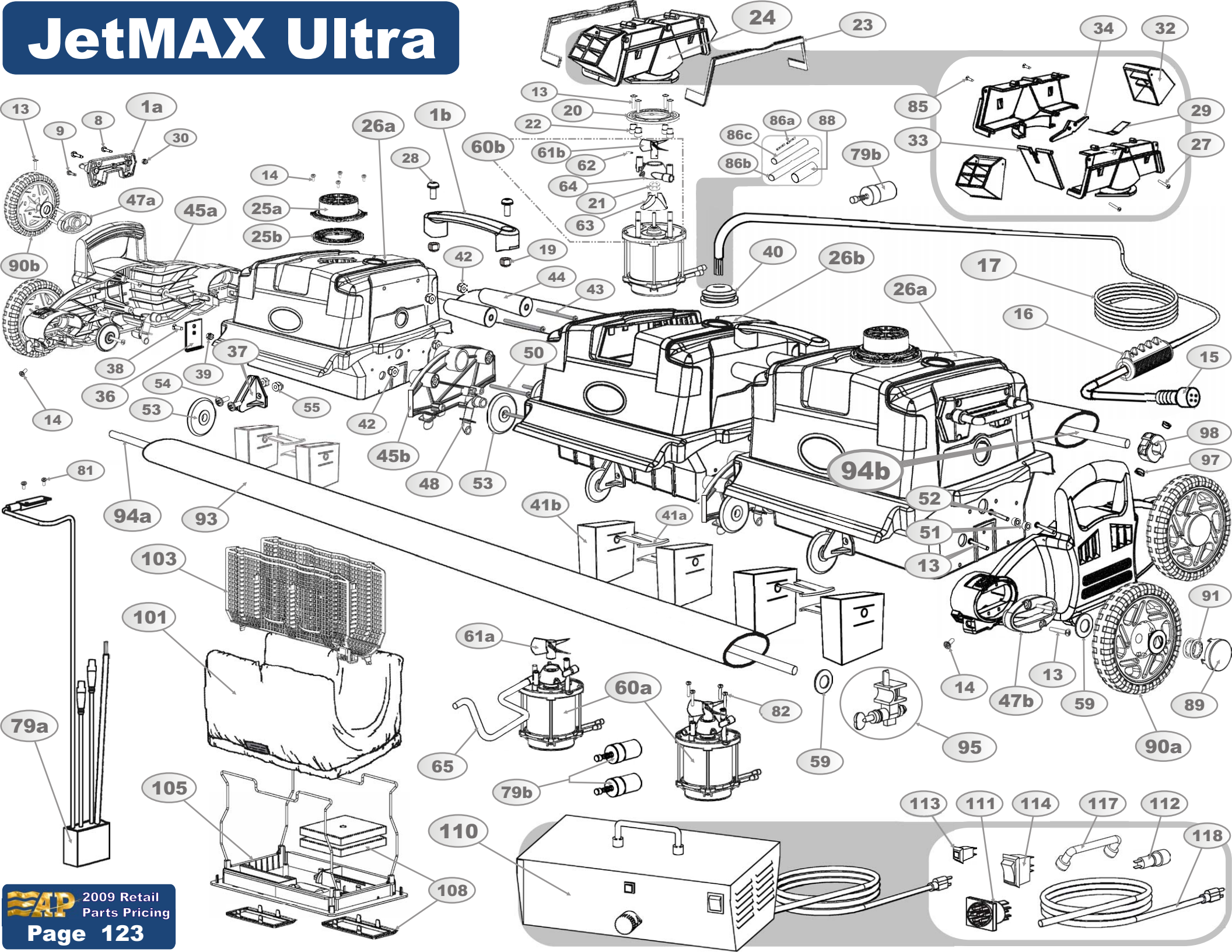

| ← IMAGE # | PART # | ITEM NAME (Description) - Quantity per | JetMAX Ultra | UNITS | LIST PRICE |
|-----------|------------|--|--------------|----------|------------|
| 1a | A70221 | HANDLE ASSEMBLY (Metal, Hinged Side Handle attached to Bracket) - 2 per machine | | EACH | \$37.31 |
| 1b | S7010 | TOP HANDLE (Black, Plastic, For top center of machine) - 2 per machine | | EACH | \$16.98 |
| 8 | 1105 | SCREW (10-32, 7/8", Phil Pan Head, fastens the Handle Bracket to the Body Assembly) - 4 per machine | | EACH | \$1.27 |
| 9 | 2304 | SCREW (10-32, 3/4", Phil Pan Head, fastens the Handle Bracket to the Body Assembly) - 4 per machine | | EACH | \$1.27 |
| 10 | 2500 | SCREW (#8, 1 1/4" Pan Head, Fastens center Pump Motor to Jet Valve Assembly) - 4 per machine | | EACH | \$1.27 |
| | 2101 | P-CLIP (5/16", Plastic, Use to secure the Cable to the Body) - 1 per machine | | EACH | \$1.27 |
| 13 | 2700 | SCREW (#8, 11/16", Phil Pan-Flat Head, to fasten Sideplate to Body, Bushing to Sideplate and Wheel to Axle) - 16 | | EACH | \$1.27 |
| 14 | 2260 | SCREW (#6, 7/16", Phil Pan-Flat Head) - Use to fasten the Outlet Tops and Locking Screw) - 12 per machine | | EACH | \$1.27 |
| 15 | 1638 | PLUG (9-Pin, Female 4-Wire connection, Only for end of the Cable that plugs into Power Supply) - 1 per machine | | EACH | \$45.79 |
| 17 | A164150 | CABLE ASSEMBLY (4-Wire, 150 Ft., 9-Pin Plug Included, 0.5" Diameter, 2-14AWG & 2-16AWG Wires) - 1 per mac | | EACH | \$922.50 |
| 19 | 2717 | LOCK NUT (Stainless Steel, to fasten the Top Handle to the Body) - 4 per machine | | EACH | \$1.27 |
| 20 | 8724 | SPACER RING (Blue, Plastic, place between Jet Valve Assembly and Pump Motor) - 1 per machine | | EACH | \$1.27 |
| 21 | 2602 | WASHER (Plastic, .75"OD x .5"ID, place under Propeller above Impeller on Pump Motor shaft) - 2 per machine | | EACH | \$0.83 |
| 22 | 2619 | SPACER (Nylon, Spacer, .6"OD x .508"ID x .612Lg., Spacer for Pump Impeller) - 4 per machine | | EACH | \$1.27 |
| 23 | 8726BK | VALVE MOUNTING EXTENSION (Black, Plastic, mounts around Jet Valve Assembly) - 2 per machine | | EACH | \$5.83 |
| 24 | A8730BK | JET VALVE ASSEMBLY (Black, Complete assembled valve housing with Extension Brackets) - 1 per machine | | EACH | \$42.38 |
| 25a | 2230K1 | OUTLET TOP (Plastic, Black, Cap) - For the top of each Side Body Assembly) - 2 per machine | | EACH | \$21.18 |
| 25b | 2250BK2 | OUTLET BOTTOM (Plastic, Black, Ring) - For the top of each Side Body Assembly) - 2 per machine | | EACH | \$9.12 |
| 26a | A2005BL1 | SIDE BODY ASSEMBLY (Blue/White, with Lock Tabs, Brass Inserts, Outlet Bottom, requires Outlet Top) - 2 per ma | | EACH | \$138.65 |
| 26b | A2005BL2SL | CENTER BODY ASSEMBLY (Blue/White with Slot, with Lock Tabs, requires Valve Housing) - 1 per machine | | EACH | \$138.65 |
| 27 | 2251 | SCREW (8-18 x 3/4", Phil Small Head) - Use to fasten the sides of the Jet Valve Assembly together | | EACH | \$1.27 |
| 28 | 2716 | SCREW (Stainless Steel, to fasten the Top Handle to the Body) - 4 per machine | | EACH | \$1.27 |
| 29 | S8731 | VALVE SPRING (St. Steel, Hinge-spring, Use inside of Jet Valve Assembly) - 1 per machine | | EACH | \$4.66 |
| 30 | SP3402 | LOCK-NUTS (Hex, Nylon insert, fastens Handle Brackets to Body) - 1 set per machine | | SET OF 8 | \$6.72 |
| 32 | 8729BK | EXTENSION BRACKET (Black, Plastic, 5 Holes, For Jet Valve) - 2 per machine | | EACH | \$23.30 |
| 33 | 8728 | VALVE FLAP (White, Plastic, Use inside of Jet Valve Assembly with Valve Lock) - 1 per machine | | EACH | \$4.66 |
| 34 | 8727 | VALVE LOCK (White, Plastic, Use inside of Jet Valve Assembly with Valve Flap) - 1 per machine | | EACH | \$4.66 |
| 36 | SP9204BL | LOCK-TABS (Blue, Plastic, holds Bottom Lid to Body) - 6 per machine | | SET OF 2 | \$3.60 |
| 37 | 3394 | BRACKET (Holds movable small black wheel, fastens to Body with screws) - 6 per machine | | EACH | \$3.60 |
| 38 | 2303 | SCREW (8-32, 1/2", Phil Bev Head, fastens Lock-Tabs between Body) - 4 per machine | | EACH | \$1.27 |
| 39 | 7133 | LOCK-NUT (8-32, Nylon Insert, Hex, For Lock-Tabs and screws between Bodies) - 12 per machine | | EACH | \$0.83 |
| 40 | 1628 | GROMMET (Rubber, .375"ID x 1.375"OD, Use around Cable Assembly on Body) - 1 per machine | | EACH | \$2.44 |
| 41a | 3477 | BRACKET (Plastic, fastens Float to inside of Body Assembly) - 6 per machine | | EACH | \$2.44 |
| 41b | 3109 | FLOAT (Grey, Foam, requires Bracket, fastened to inside of Body Assembly) - 6 per machine | | EACH | \$3.60 |
| 42 | 8305 | NUT (10-32, Nylon Insert, fastens Body Assemblies together at the top of unit) - 4 per machine | | EACH | \$0.83 |
| 43 | 8323 | SCREW (10-32, 3/4", fastens Body Assemblies together at the top of unit) - 4 per machine | | EACH | \$2.44 |
| 44 | S2905 | UPPER SPACER (3/4" x 2 1/2", Plastic, Black, to space apart Body Assemblies) - 4 per machine | | EACH | \$12.00 |
| 45a | 3350BK | SIDEPLATE (New improved design, Black, Plastic, requires Bushings and Locking Screw Assembly) - 2 per machin | | EACH | \$46.62 |
| 45b | S3388BK | MIDDLE SIDEPLATE (Blue plate for between Body Assemblies) - 2 per machine | | EACH | \$31.85 |
| 47a | 3351WT | BUSHING (White, Plastic, with hole, fastens to Sideplate, for non-sliding Fixed-Wheel Axle) - 2 per machine | | EACH | \$2.76 |
| 47b | 3352WT | BUSHING (White, Plastic, with slot, fastens to Sideplate, for sliding Free-Wheeling Axle) - 2 per machine | | EACH | \$2.76 |
| 48 | 3398 | JET NOZZLE (Black, Plastic, Fits into Jet Bracket and connects to Tubing for Power Washing) - 6 per machine | | EACH | \$4.98 |
| 50 | 2711 | SCREW (8-32, 2 3/4", fastens Body Assemblies together through Middle Sideplate) - 8 per machine | | EACH | \$1.20 |
| 51 | 2598 | BUSHING (Nylon, 3/8"OD x .194"ID, Spacer for Sideplate top Screws) - 4 per machine | | EACH | \$1.27 |
| 52 | 4612 | SCREW (18-8, #8 x 1.08", Phil Pan Head, to fasten Sideplate to Body through Bushings) - 4 per machine | | EACH | \$1.27 |
| 53 | 3393BK | SMALL WHEEL (Black, For inside Sideplate, between Bodies and attached to side of Body with Bracket) - 12 per m | | EACH | \$3.16 |
| 54 | 2719 | SCREW (Stainless Steel, 8-32 x 3/8", to fasten Wheel Bracket to Body) - 12 per machine | | EACH | \$1.27 |
| 55 | 2706 | LOCK NUT (8-32, Fastens center wheel bracket to body) - 12 per machine | | EACH | \$0.83 |
| 59 | 2607 | WASHER (Delrin, For between Wheel and Sideplate and outside of Wheel on movable axle) - 6 per machine | | EACH | \$1.80 |
| 60a | A601503 | PUMP MOTOR (Side Pumps, 30V, Propeller, Impeller, 2-Pin Fem to Capacitor, 2-Pin Male to Junction) - 2 per mach | | EACH | \$213.79 |
| 60b | A6038 | PUMP MOTOR (Center Pump, 38V, With Capacitor, Propeller, Red Impeller, 2-Pin Male Connect for J-Box) - 1 per i | | EACH | \$213.79 |
| 61a | 4400 | PROPELLER (Black, Plastic, for side Pump Motor, pushed onto shaft) - 2 per machine | | EACH | \$12.25 |
| 61b | S6400 | PROPELLER (Black, Plastic, for center Pump Motor, requires Set Screw) - 1 per machine | | EACH | \$12.25 |
| 62 | 6207 | SET SCREW (Stainless Steel, 8-32 x 1/4", for center Pump Motor Propeller) - 1 per machine | | EACH | \$1.27 |
| 63 | 6027 | IMPELLER (Red) - 3 per machine | | EACH | \$12.25 |
| 64 | 6028 | IMPELLER HOUSING (Red) - 3 per machine | | EACH | \$12.25 |
| 65 | 300096 | TUBING (Clear PVC, 5/16"ID x 1/2"OD) - Use to divert water from the Impeller to the Jet Bracket) - 6 feet per machin | | PER FOOT | \$1.10 |
| 79a | A2415 | JUNCTION BOX ASSEMBLY (bare wire set for Cable, 2-Pin Female Connect for Pumps, Magnet Sensor) - 1 per m | | EACH | \$95.40 |
| 79b | 6012 | RUNNING CAPACITOR (Blue, Cylinder, 2-Pin Male Connect to Pump Motor) - 3 per machine | | EACH | \$35.00 |
| 81 | 8321 | SCREW (8-18, #4 x 1/4", Phil Pan Head, to fasten the Magnet Sensor to Sideplate) - 2 per machine | | EACH | \$1.27 |
| 82 | 2302 | SCREW (#8, 3/4", Phil Pan Head, To fasten the Side Pump Motors to the Body) - 8 per machine | | EACH | \$1.27 |
| 85 | 4501 | SCREW (8-18 x 1/2", Phil Pan Head) - Use to fasten the Extension Brackets to the Jet Valve) - 4 per machine | | EACH | \$1.27 |
| 89 | 2670CBK | WHEEL COVER (Black, Dome Disc, Snaps-in Hub) - 4 per machine | | EACH | \$2.86 |
| 90a | 2670 | WHEEL ASSEMBLY (Free-Wheeling on Axle, Black, Rubber, 6", includes Wheel Cover) - 2 per machine | | EACH | \$9.33 |
| 90b | S2670BKH | WHEEL ASSEMBLY WITH HOLE (Fixed-Wheel on Axle, Black, Rubber, 6", includes Wheel Cover) - 2 per machine | | EACH | \$9.33 |
| 91 | 11067 | STAR WASHER (Stainless Steel, holds Wheels on Free-Wheeling Axles, used in pairs) - 4 per machine | | EACH | \$3.60 |
| 93 | S101939 | TUBE (Black, Plastic, 3" Oval, 39" Long, for back of machine) - 2 per machine | | EACH | \$30.14 |
| 94a | S3433 | AXLE (White, Fiberglass, 43.375" x 1/2"OD, no holes, Free-Wheeling Axle) - 1 per machine | | EACH | \$30.86 |
| 94b | S3433H | AXLE (White, Fiberglass, 43.375" x 1/2"OD, three holes, Fixed-Wheel Axle, requires Magnet and Clip) - 1 per machin | | EACH | \$30.86 |
| 95 | S8740KIT | LOCKING SCREW ASSEMBLY (Nylon, Stainless Steel, for Free-Wheeling Axle settings) - 2 per machine | | EACH | \$9.98 |
| 97 | 4629 | MAGNET (Neodymium, 0.25" x 0.2", for Fixed Axle, requires Clip) - 2 per machine | | EACH | \$1.27 |
| 98 | 4630 | CLIP (Black, Plastic, fastens onto Fixed Axle, requires Magnets) - 1 per machine | | EACH | \$1.27 |
| 101 | 8111 | FILTER BAG (Optional, Small, Fine Filter Bag) - 3 per machine | | EACH | \$48.97 |
| 101 | 8112 | FILTER BAG (Small, Mesh Filter Bag) - 3 per machine | | EACH | \$46.75 |
| 103 | SP5310 | FILTER SCREEN (Blue, Folding Cage with Attachment Strings, for Side Bodies) - 2 per machine | | EACH | \$27.88 |
| 103 | S5315 | FILTER SCREEN (Blue, Folding Cage with Attachment Strings, for Center Body) - 1 per machine | | EACH | \$27.88 |
| 105 | A9600BL | BOTTOM LID ASSEMBLY (Blue, Shallow-W-Shaped Wire Frame) - 3 per machine | | EACH | \$99.00 |
| 108 | SPK9600 | FLOAT KIT (Optional, includes floats and Bottom Lid Extension Brackets) - 3 sets per machine | | SET OF 4 | \$15.35 |
| 110 | A7167 | POWER SUPPLY (9-Pin Male, Double Transformer, 40/36 volts, Safety Reset Button) - 1 per machine | | EACH | \$458.16 |
| 111 | SP7140 | SOCKET ASSEMBLY (9-Pin, Male, use for 4-Wire Cable) - 1 on Power Supply | | EACH | \$34.55 |
| 112 | 7005 | FUSE HOLDER (Standard, Push & Turn style) - 1 on Power Supply | | EACH | \$8.14 |
| | 7008 | FUSE (8 Amp, 250 Volt, Slow-Blow) - 1 on Power Supply | | EACH | \$3.07 |
| 113 | 7111 | RESET SWITCH (Square button, 2-Wire) - 1 on Power Supply | | EACH | \$11.66 |
| 114 | 7107 | LIGHTED SWITCH (Thin, 1 1/4" x 1/2", Red with Light, Water resistant cover) - 1 on Power Supply | | EACH | \$8.16 |
| 117 | 7064 | HANDLE (Metal, Hinged, with Hardware) - 1 on Power Supply | | ASSEMBLY | \$13.98 |
| 118 | 7102 | CORD FOR POWER SUPPLY (3-Wire, Green, Black, and White) - 1 on Power Supply | | EACH | \$11.66 |

→ Parts marked with this symbol should be installed by the Factory or an Authorized Service Center. Otherwise a Warranty Waiver must accompany any order for these parts.